

# RAINBOW HIGH™

## HOUSE

**WARNING:**  
CHOKING HAZARD-Small parts.  
Not for children under 3 years.

SKU: 574330  
AGES 6+

ADULT ASSEMBLY REQUIRED



WATCH THE HOUSE ASSEMBLY VIDEO:  
[RAINBOWHIGH.COM](https://www.rainbowhigh.com)



Illustrations are for reference only. Styles may vary from actual contents.  
Please remove all packaging including tags, ties & tacking stitches before giving this product to a child.

Please keep this manual as it contains important information.



0421-0-E/INT  
Printed in China

[WWW.RAINBOWHIGH.COM](http://WWW.RAINBOWHIGH.COM)  
©2021 MGA Entertainment, Inc.  
RAINBOW HIGH™ is a trademark of MGA in the U.S. and other countries. All logos, names, characters, likenesses, images, slogans, and packaging appearance are the property of MGA.

The preferred method of contact for Customer Service is through our e-mail contact form at [www.mgae.com](http://www.mgae.com)

#COLLECTTHERAINBOW

**MGA Entertainment, Inc.**  
9220 Winnetka Ave. Chatsworth, CA 91311  
U.S.A.  
(800) 222-4685

**MGA Entertainment UK Ltd.**  
50 Presley Way, Crownhill, Milton Keynes,  
MK8 0ES, Bucks, UK  
+ 0800 521 558

**MGA Entertainment (Netherlands) B.V.**  
Baronie 68-70, 2404 XG Alphen a/d Rijn,  
The Netherlands  
Tel: +31 (0) 172 758038

**Imported by MGA Entertainment Australia Pty Ltd.**  
Suite 2.02, 32 Delhi Road  
Macquarie Park NSW 2113  
1300 059 676

### **WARNING**

- ADULT ASSEMBLY REQUIRED.
- ADULT SUPERVISION IS REQUIRED when children are playing in or around water.
- Prior to assembly, this package contains small parts: screws which are a choking hazard and may contain sharp edges and sharp points. Keep away from children until assembled.
- Avoid placing the house on an uneven surface or anywhere which might offer the possibility of tipping.
- Do not sit, stand, or jump on the house, as doing so may result in bodily injury and/or damage to the unit.
- Not suitable for children under 3 years of age due to size limitations.
- Only use clean, room temperature water with the bathtub, sink and jacuzzi. Always empty water and allow it to air dry thoroughly before storing.
- Always check the condition of the product before giving to children. Do not use if the product is worn or damaged. Dispose the product immediately if broken.
- Do not give to a child under the intended age group.
- For correct assembly, follow these instructions. Please retain packaging and instruction manual for future reference.
- Clean the product before and after using. Immediately wipe up spilled water after playing.
- Only use a dry cloth to clean the product. Never use a corrosive or abrasive substance to clean the product.

# CONTENTS

Before assembling, ensure you have all pieces.  
Some furniture assembly may be required prior to assembling the house.

A	B	C	D	E
F	G	H	I	J
K	L	M	N	O
1	2	3	4	5
6	7	8	9	10
11	12	13	14	15

# WALL MOUNTING ASSEMBLY

- For added safety and stability, install the wall mounting hardware.
- Always use wall anchors appropriate to your wall type, like plaster, drywall, concrete, etc.
- When possible, mount to wood studs.
- Consult a qualified professional for mounting.

### HARDWARE

- |                         |                     |
|-------------------------|---------------------|
| A. Screw<br>            | E. Wood Screw<br>   |
| B. Small Washer x 2<br> | F. Nut<br>          |
| C. Plastic Strip<br>    | G. Large Washer<br> |
| D. Plastic Anchor<br>   | H. Wrench<br>       |

### NOT INCLUDED

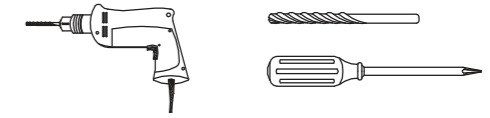

**1** Attach the plastic strip to the back of the product. There is a pre-drilled hole on the house's backboard (J).

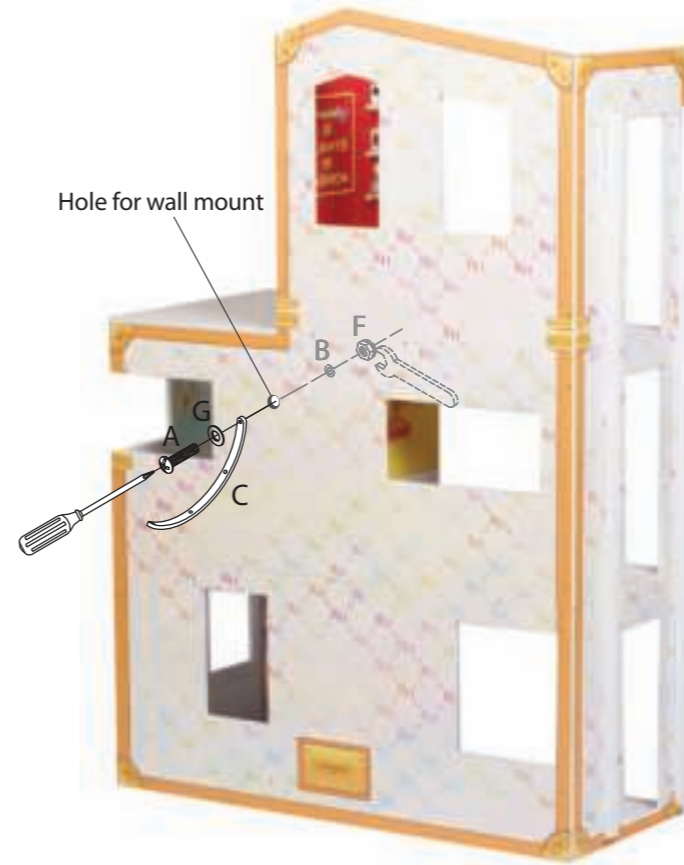

**2** Use a 1/4" (6.5 mm) drill bit to drill a pilot hole in the wall.  
• DO NOT drill an oversized hole, or the anchor will not hold tightly to the wall.  
• Tap the wall anchor into the hole.  
• Secure the house to the wall with a screw (E) through the plastic strip and into the wall anchor.



## ! WARNING

- DO NOT install on a wall where items can fall off and injure a child.
- CHOKING HAZARD: Unassembled parts may be a choking hazard to children 3 years and younger.
- Adult assembly required. Hardware contains small screws with sharp points. Keep unassembled parts out of reach of small children.
- Serious or fatal injuries can occur from furniture tipping over. To prevent the product from tipping over:
  - Use mounting hardware to secure the house to a wall. This will reduce, but NOT eliminate, the risk of tipping over.
  - DO NOT allow children to climb on the house.
- Keep remote controls, toys, and other items that might attract children away from this product.
- DO NOT place heavy items, like televisions, on top of this product.

## FURNITURE CONTINUED

Some furniture items have water features. Pour water into the furniture and press the button to see the water feature.

Before beginning, cover the play area to prevent possible water damage.

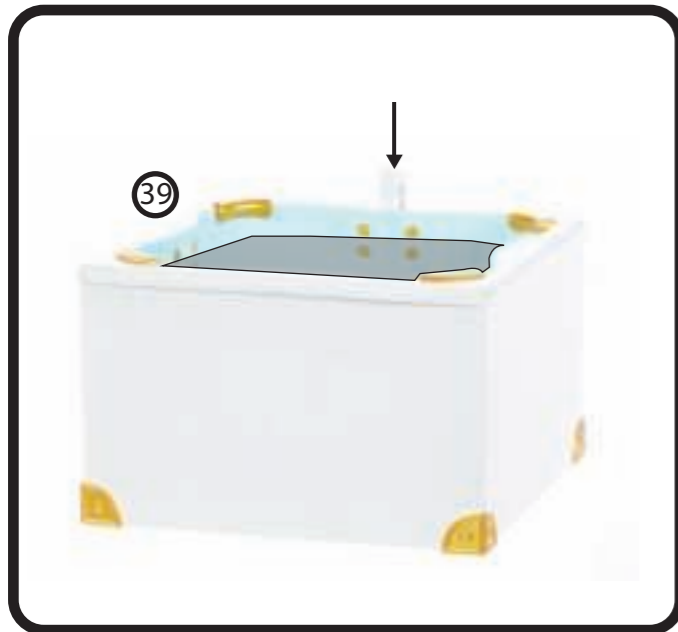

Make sure to fill above the jet holes, but avoid overfilling.

## CONTENTS

16	17	18	19	20
21	22	23	24	25
26	27	28	29	30
31	32	33	34	35
36	37	38	39	40
41 x 68	42 x 2	43 x 3	44	45 x 7
3.5*25mm	4*15mm			4*12mm

# FURNITURE ASSEMBLY

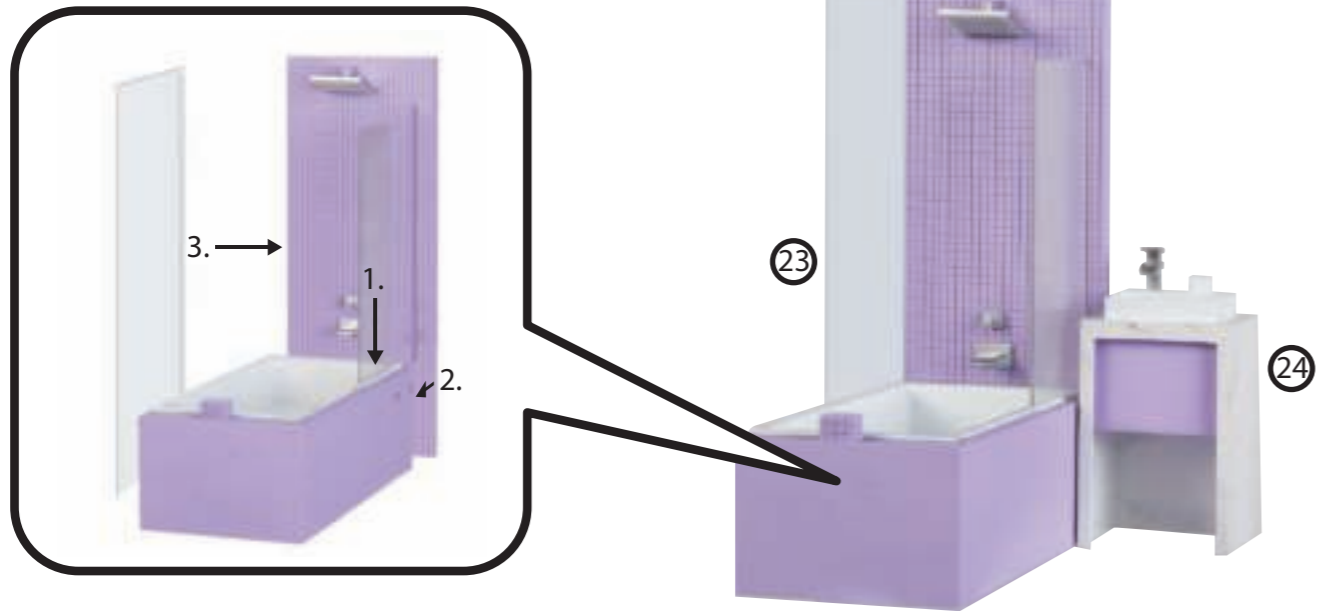

# FURNITURE

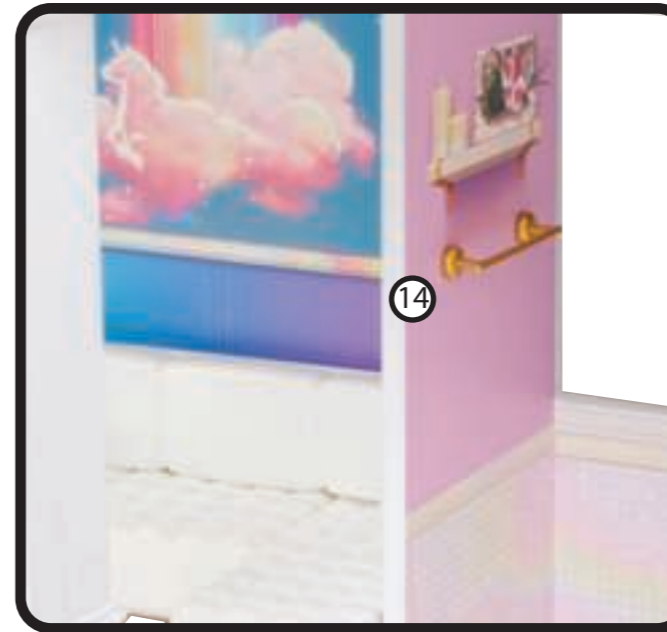

Push button to see the washer spin.



Place the refrigerator furniture first and then slide the sink.



When sliding the elevator up or down, hold from the ribs on both sides.

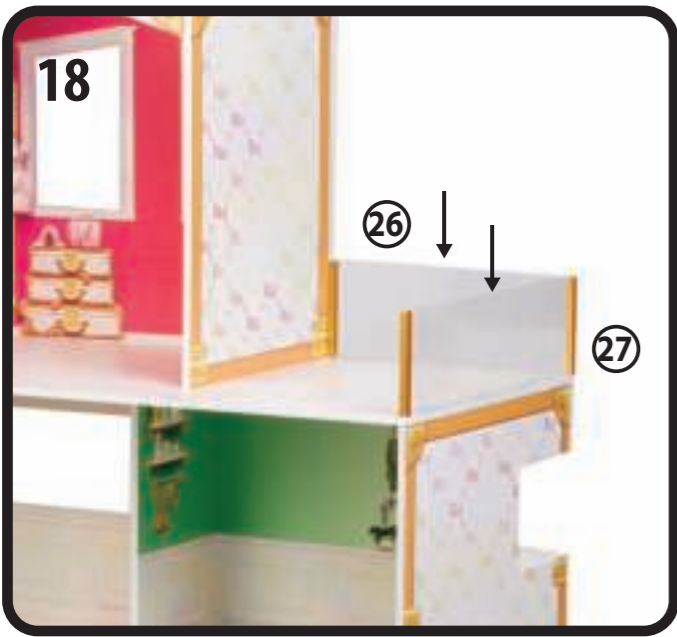
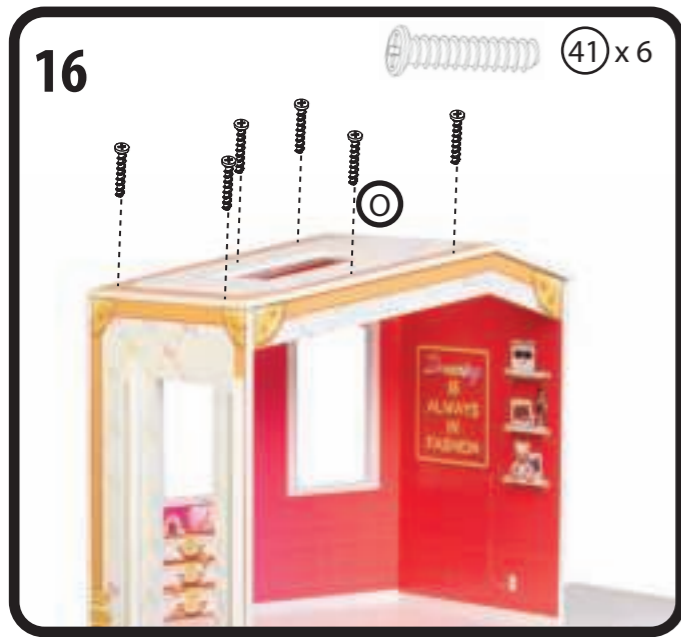

**ADULT ASSEMBLY REQUIRED**

