

CLIP:

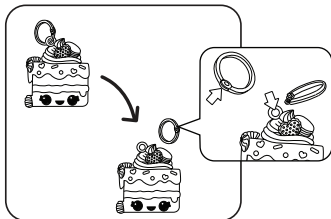

Open the clip to hook and remove from scent roller.

Illustrations are for reference only. Styles may vary from actual contents. Please remove all packaging including tags, ties & tacking stitches before giving this product to a child.



0824-0-E
Printed in China

©2024 MGA Entertainment, Inc.
YUMMILAND™ is a trademark of MGA in the U.S. and other countries. All logos, names, characters, likenesses, images, slogans, and packaging appearance are the property of MGA.

MGA Entertainment, Inc.
9220 Winnetka Ave.
Chatsworth, CA 91311 U.S.A.
(800) 222-4685

The preferred method of contact for Customer Service is through our e-mail contact form at www.mgae.com

YUMMILAND™

Ages 4+



SKUs: 526476

ADULT SUPERVISION REQUIRED

CONTENTS

- a. 1 Character
- b. 1 Clip
- c. 1 Pouch of Scent Color
- d. 1 Pouch of Base Liquid

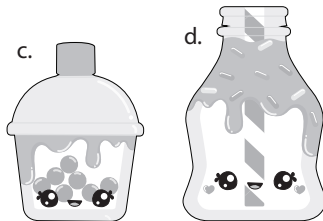
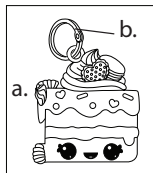

⚠️WARNING

- Not suitable for children under 4 years. For use under adult supervision. Read the instructions before use, follow them and keep them for reference. Keep the kit out of reach of children under 4 years old. If swallowed: Wash out mouth with water and drink some fresh water. Do not induce vomiting. Seek immediate medical advice.
- For use under adult supervision. May cause allergic reaction. Wash hands thoroughly after use.
- DO NOT apply scent roller around eyes.
- Cosmetics should not be used for purposes other than those listed in these instructions.
- Cosmetics are for external use only. Discontinue use if signs of irritation or rash appear. Do not use on broken skin.
- These cosmetics are laboratory tested and safe for use as prescribed. As with all cosmetics, some individual skin types may experience minor skin irritation to ingredients. If skin rash, irritation, sensitization or other allergic reactions occur, discontinue use immediately and seek medical advice.
- Do not ingest or inhale any of the cosmetics or contents included in this package.
- Avoid direct contact with eyes. If this occurs, flush with water immediately. If inflammation occurs or pain persists, seek medical advice.

IMPORTANT INFORMATION

- Protect and cover surrounding surfaces before use to prevent possible damage or staining. Color transfer may occur.
- Products may damage or stain certain fabrics, carpeting, wood finishes, or other porous and polished surfaces.
- Keep paper towels (not included) handy for cleaning up spills, wiping fingers, etc.
- Store components in a cool, dry environment.
- Wash hands before and after using cosmetics.
- Tightly close all lids and caps after use.
- Do not dispose of the cosmetics in the drain. Dispose in a trash receptacle once you are finished using it.
- Discontinue use if cosmetics have been left opened for a long period of time or if it has gotten dirty.
- Do not leave cosmetics in direct sun or in very hot areas.

QUICK START:

Before beginning, wash and dry hands thoroughly, then cover the play area to prevent possible damage.

NOTE: Contents of this kit may not be used to create items for resale.

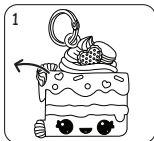

Remove the cap and set aside.

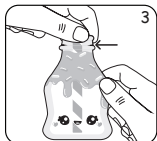

Massage components together before starting. Then, tear the soda bottle pouch open at the notch on the straw.

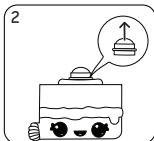

Remove the rollerball stopper and set aside.

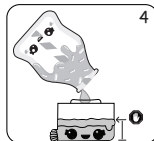

Add in the base liquid. Leave space in the container to add in the scent color liquid.

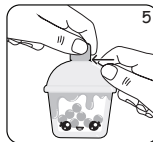

Tear open the boba pouch at the notch on the cap.

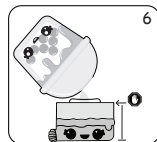

Add the scent color into the scent roller container. Ensure you do not overfill the container.

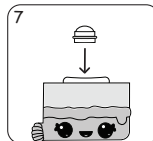

Insert the rollerball stopper into the top opening.

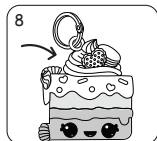

Place the cap on. Keep cap on when not in use. NOTE: Ensure the cap is lined up with the indent on the body to close properly.

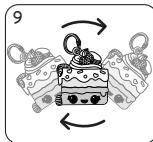

Shake the mixture to combine components evenly.

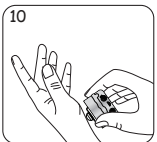

Apply the scent roller onto your skin.



NOTE:

Use the included blister to stabilize "Mr. Pops" when adding liquid components inside the scent roller container.